

**CENTRAL ILLINOIS MOSQUE AND ISLAMIC CENTER (CIMIC)
OUTREACH COMMITTEE (DPC)**
106 S. Lincoln, Urbana, IL 61801
Phone: 217-344-1555

dpc@cimic.org

www.cimic.org

Welcome to CIMIC

We would like to warmly welcome you to the Central Illinois Mosque and Islamic Center (CIMIC). It is our pleasure to host visitors at CIMIC, whether returning or first-timers. To make your visit to CIMIC informative, pleasant, educational, and enjoyable, here are a few points to consider prior to your visit to CIMIC:

Visit times:

The mosque is open everyday for the five daily congregational prayers. We suggest that you check CIMIC website www.cimic.org or send an e-mail to dpc@cimic.org for scheduling a visit. Friday (Jumu'ah) Prayer time is generally recommended for visits (1:00 to 2:00pm). Other days and times can also be arranged.

Access to CIMIC

Pedestrian access from Lincoln-side entrance is only available on Fridays from 1:00 to 2:00PM. Other access times through Lincoln-side entrance can be requested ahead of the visit. We recommend using Busey entrance, which is also handicap accessible.

Parking:

The mosque parking lot is accessible through Busey Street, a block east of Lincoln Ave. Please take extra care not to park in the parking lots of neighboring residences.

When visiting on Fridays, it is generally a good idea to arrive before 12:45PM to ensure parking spot(s) at the CIMIC parking lot.

[Additional roadside parking](#) is available on Springfield, both west and east of Lincoln Avenue.

Pets:

No pets are allowed inside the mosque.

Welcome to the Mosque- Information for Visitors to Central Illinois Mosque and Islamic Center (CIMIC)

Attire:

Both men and women are requested to wear conservative attire when visiting the mosque. Shorts, short skirts, and sleeveless tops are strongly discouraged, as well as steeping necklines. Women are not required to cover their hair, but doing so would be greatly appreciated. For men knee-length shorts are acceptable.

Decorum

Seating

Generally, we assign separate seating for both genders. While the Friday sermon (khutba) is being delivered or prayer is being performed, we request those who are present to refrain from talking.

Photography

If interested in taking photos, please let us know as soon as you arrive, so we can make you aware of specific guidelines.

Shoes:

Depending on the activity, you may be requested to remove your shoes when entering areas beyond the foyers. When entering main prayer area (*musallah*) please remove shoes.

Site Map:

See below site and parking maps.

Additional Information:

Please do not hesitate to contact us, if any clarification is needed.

Visit www.CIMIC.org, e-mail dpc@cimic.org or call 217 344 1555.

P.S. CIMIC premises are monitored round the clock through a closed-circuit system

We hope you enjoy and benefit from your visit to our center. Feel free to ask any type of questions. CIMIC is a community resource and we encourage you to make the most of your visit and we look forward to getting to know you.

Thank You for Visiting!

Welcome to the Mosque- Information for Visitors to Central Illinois Mosque and Islamic Center (CIMIC)

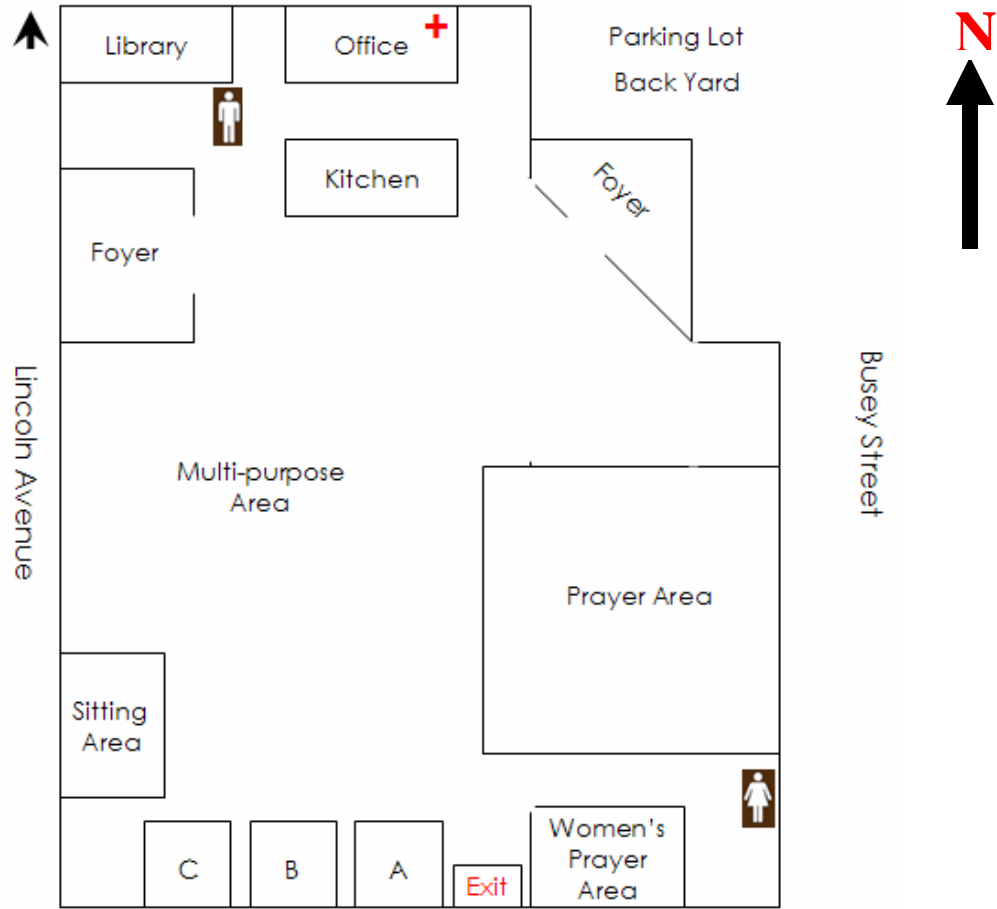

CIMIC Location Map and Additional Parking

